

CERTIFIED LAND CORNER RECORDATION

DESCRIPTION OF CORNER EVIDENCE FOUND, AND ORIGINAL RECORD (If known)
 FOUND: A STANDARD WYOMING HIGHWAY DEPARTMENT
 MONUMENT STAMPED AS SHOWN

T. 14 N.
 19 | 20
 30 | 29
 R. 66 W.

**DESCRIPTION OF MONUMENT AND ACCESSORIES ESTABLISHED
 TO PERPETUATE THE ORIGINAL LOCATION OF THIS CORNER:**

SEE TIES BELOW

SKETCH, WITH COURSE AND DISTANCE TO ADJACENT CORNER IF DETERMINED IN THIS SURVEY.
 (May Sketch or Paste Reproduction on Reverse Side.)

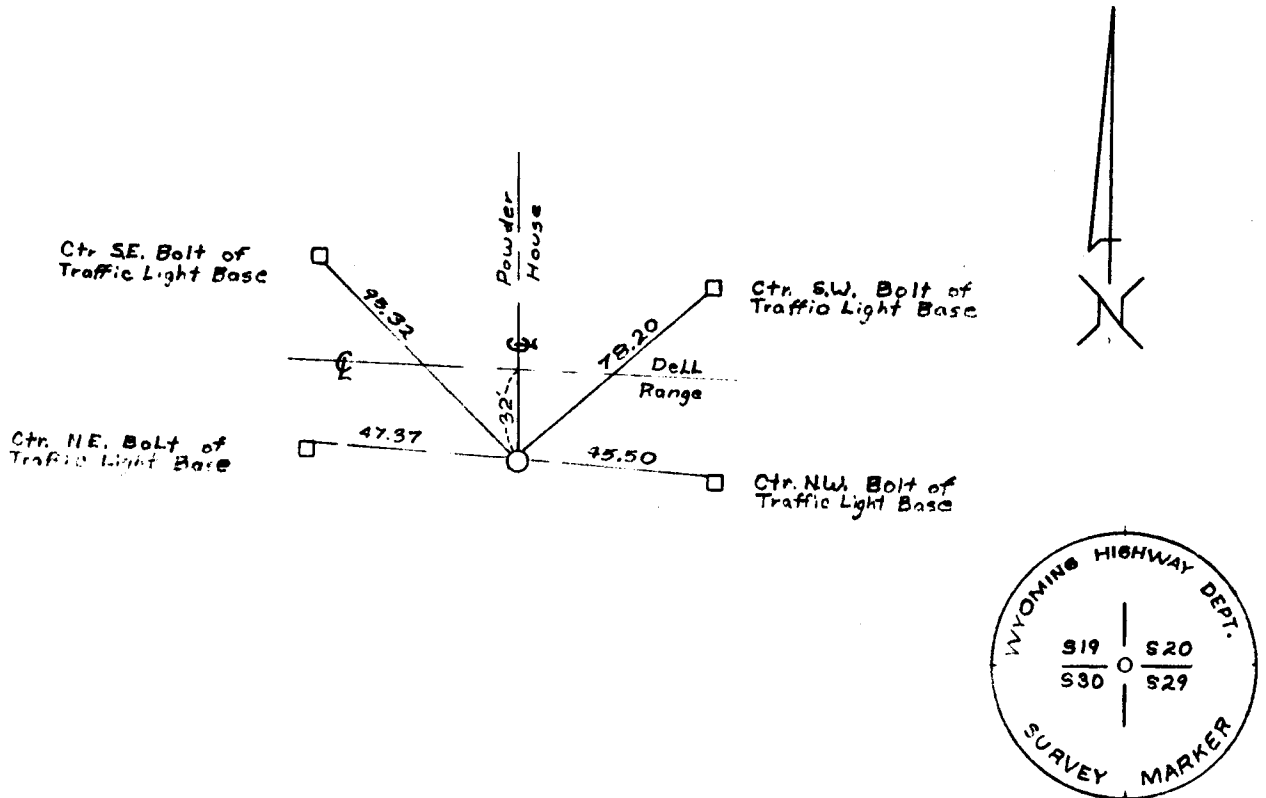

I, JOHN A. STEIL certify that I have carefully performed or reviewed the work done on the diagrammed corner as reported on this recordation form and approve the same.

John A. Steil Signature of Surveyor
 2500 Registration No.

STATE OF WYOMING,
 Office of Clerk and Recorder,
 County of Laramie

649909

This "corner record" was filed for record on the MAR 5 day of 1982, 19 , was noted on the cross-index plat and is assigned page No. , in book No.

Janet C Whitehead
 County Official

Cross Index No. <u>R-5</u>	T. <u>14</u>	R. <u>66</u>	Mer.
_____	T. _____	R. _____	Mer.
_____	T. _____	R. _____	Mer.
_____	T. _____	R. _____	Mer.
_____	T. _____	R. _____	Mer.
_____	T. _____	R. _____	Mer.
_____	T. _____	R. _____	Mer.

R-5 (3)